

Duplex GeoSeal High Flow Coalescing Filter

150 psi - *10.3 bar*

Up to 1,800 gph - *Up to 6,800 L/h*

GHCFD

Up to 50 gpm - *Up to 189 L/min*



Features and Benefits

- **Duplex Filter Design:** Incorporates two parallel filters that can operate simultaneously or independently.
- **Continuous Operation:** One filter can be serviced or cleaned while the other is still filtering, ensuring no system downtime.
- **Easy Maintenance:** Provides quick access to filters for maintenance without interrupting the engine's operation.
- **High Filtration Efficiency:** Capable of filtering out fine particles and water to improve fuel cleanliness.
- **Durable Construction:** Built from high-quality anodized aluminum, ensuring long-lasting performance in the most challenging environments.
- **Compact and Space-Efficient:** Designed to fit within tight spaces, ideal for applications with limited room and in need of weight savings.
- **Versatility:** Suitable for a wide range of high horsepower diesel engine applications.

Fluid Compatibility - Fuel Oils

- Diesel Fuel; Fluids; Renewable Diesel/HVO
- For other distillate petroleum, contact factory

Markets



BULK FUEL
FILTRATION



DEFENSE



INDUSTRIAL



MARINE SHIP
BUILDING



MINING
TECHNOLOGY



OIL & GAS



POWER
GENERATION



RAILROAD

Duplex GeoSeal High Flow Coalescing Filter

GHCFD

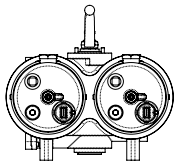
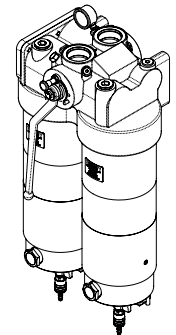
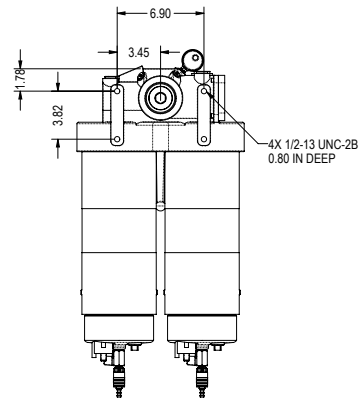
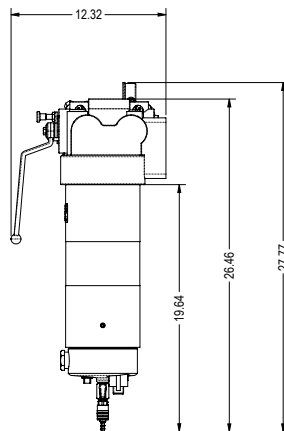
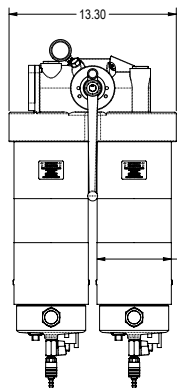
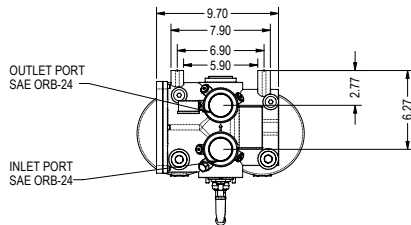

Filter Housing Specifications

Flow Rating: For Suction Installations - Up to 1,800 gph (Up to 6,800 L/hr) in center valve position, 900 gph (3,410 L/hr) in the left/right valve position. For Pressure Installations - Up to 50 gpm (189 L/min) in center valve position, Up to 25 gpm (95 L/min) in the left/right valve position.

Max. Operating Pressure: 150 psi (10.3 bar)

Min. Yield Pressure: 1650 psi (65 bar)

Temp. Range: Operating Temperature Range: -20° F to 225° F (-29° C to 107° C)

Bypass Setting: Blocked for Suction Installations, 40 PSI (2.8 bar) for pressure side installations.

Materials of Construction: Filter Assembly: Anodized Aluminum
Valve: Stainless Steel
Sealing Material: FKM & PTFE

Weight: 54.3 lbs. (24.6 kg.)

Element Change Clearance: 4.5 inches (114 mm)

Duplex GeoSeal High Flow Coalescing Filter

GHCFD

Element Part Number Selection

Pressure Side Coalescing		
Coalescing Element	Max Flow	Single Pass Water Removal Efficiency
C125GZ5V	25 gpm	>95%

Notes: Contact Factory for Filtration Media Options Available in 1, 2, 3, 5, 7, 10, 25, & 30 micron

Coalescing Element Flow Direction: Inside-to-Outside

Element Nominal Dimensions: 5" (127 mm) O.D. x 12" (305 mm) long

How to Build a Valid Model Number for a Schroeder GHCFD:

<input type="text" value="GHCFD"/>	<input type="text"/>	<input type="text"/>	<input type="text"/>	<input type="text"/>	<input type="text"/>	<input type="text"/>
Filter Series	Coalescing Filtration	Element Seal Material	Bypass	Inlet / Outlet Porting	Indicator Options	Sump Options

**Starting from the left to the right you will choose your GHCFD and work your way through each category as illustrated above.

SUCTION SIDE MODEL CODE BUILDER

Filter Series	Coalescing Filtration		Element Seal Material
<input type="checkbox"/> GHCFD	<input type="checkbox"/> CG5 = C125GZ5V 5 Micron Coalescing Element		<input type="checkbox"/> V = Viton®
Bypass	Inlet / Outlet Porting	Indicator Options	Options
<input type="checkbox"/> X = Blocked	<input type="checkbox"/> S24 = SAE-24	<input type="checkbox"/> Omit = No Indicator Port <input type="checkbox"/> YR = Vacuum Gauge Mounted on Right Side of Filter Head <input type="checkbox"/> YL = Vacuum Gauge Mounted on Left Side of Filter Head	<input type="checkbox"/> T = WIF <input type="checkbox"/> Omit = Sump Sight Glass (Standard)

Notes: Contact factory for other options or configurations not included.

PRESSURE SIDE MODEL CODE BUILDER

Filter Series	Coalescing Filtration		Element Seal Material
<input type="checkbox"/> GHCFD	<input type="checkbox"/> CG5 = C125GZ5V 5 Micron Coalescing Element		<input type="checkbox"/> V = Viton®
Bypass	Inlet / Outlet Porting	Indicator Options	Options
<input type="checkbox"/> Omit = 40 psid	<input type="checkbox"/> S24 = SAE-24	<input type="checkbox"/> Omit = No Indicator Port <input type="checkbox"/> D5 = Visual pop-up w/manual reset	<input type="checkbox"/> T = WIF <input type="checkbox"/> Omit = Sump Sight Glass (Standard)

Notes: Contact factory for other options or configurations not included.